

# ***Amcor***

PAD RETAINERS

*Flats hold with wrench*

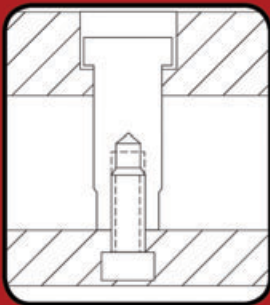

*Flats hold with Locking Pin*

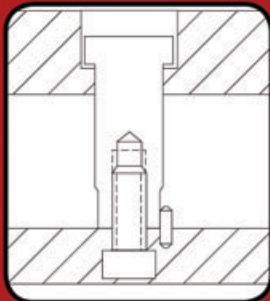

*Holds with lock washer or nyloc screw*

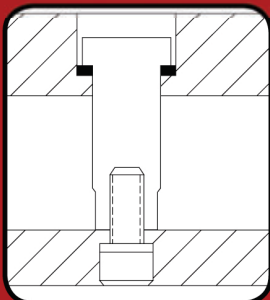

**AVAILABLE IN:**  
***Reversed Style, Locking Style,***  
***Counterbored Style, Metric***  
***and Standard***

- *Increase safety and strength to your pad retention*
- *Eliminate stripper bolts*
- *Quick and easy pad removal*
  - *Well stocked*
- *Custom sizes & styles available*
  - *Made in the USA*

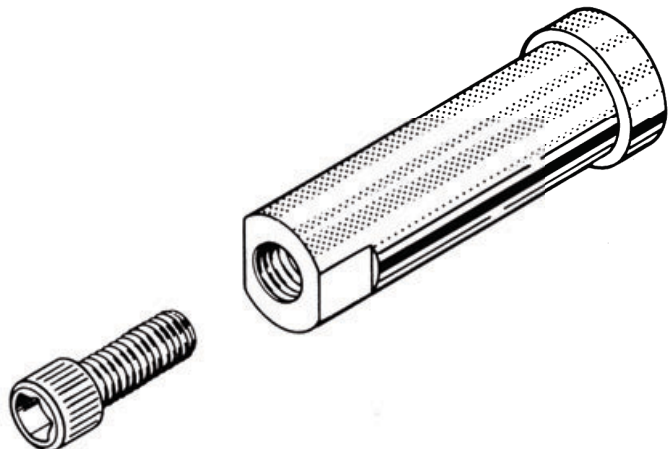



# Reversed Style Pad Retainers

## PR Series

### 0.75" DIAMETER 3/8-16 TAP

ITEM NUMBER	LENGTH
PRO-04	1.00
PRO-05	1.25
PRO-06	1.50
PRO-07	1.75
PRO-08	2.00
PRO-09	2.25
PRO-10	2.50
PRO-11	2.75
PRO-12	3.00
PRO-13	3.25
PRO-14	3.50
PRO-15	3.75
PRO-16	4.00
PRO-18	4.50
PRO-20	5.00
PRO-22	5.50
PRO-24	6.00
PRO-26	6.50

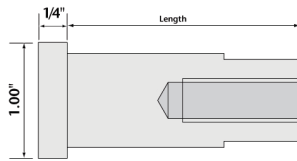

## PR Series

### 0.812" DIAMETER 5/16-18 TAP

ITEM NUMBER	LENGTH
PROX-04	1.00
PROX-05	1.25
PROX-06	1.50
PROX-07	1.75
PROX-08	2.00
PROX-09	2.25
PROX-10	2.50
PROX-11	2.75
PROX-12	3.00
PROX-13	3.25
PROX-14	3.50
PROX-15	3.75
PROX-16	4.00
PROX-18	4.50
PROX-20	5.00
PROX-22	5.50
PROX-24	6.00
PROX-26	6.50

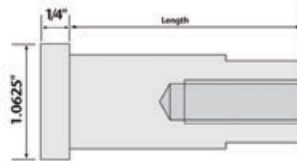

## PR Series

### 1.00" DIAMETER 1/2-13 TAP

ITEM NUMBER	LENGTH
PR1-04	1.00
PR1-05	1.25
PR1-06	1.50
PR1-07	1.75
PR1-08	2.00
PR1-09	2.25
PR1-10	2.50
PR1-11	2.75
PR1-12	3.00
PR1-13	3.25
PR1-14	3.50
PR1-15	3.75
PR1-16	4.00
PR1-18	4.50
PR1-20	5.00
PR1-22	5.50
PR1-24	6.00
PR1-26	6.50

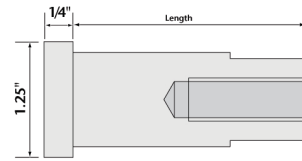

## PR Series

### 1.25" DIAMETER 5/8-11 TAP

ITEM NUMBER	LENGTH
PR2-05	1.25
PR2-06	1.50
PR2-07	1.75
PR2-08	2.00
PR2-09	2.25
PR2-10	2.50
PR2-11	2.75
PR2-12	3.00
PR2-13	3.25
PR2-14	3.50
PR2-15	3.75
PR2-16	4.00
PR2-18	4.50
PR2-20	5.00
PR2-22	5.50
PR2-24	6.00
PR2-26	6.50

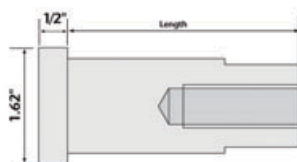

## PR Series

### 1.50" DIAMETER 3/4-10 TAP

ITEM NUMBER	LENGTH
PR3-06	1.50
PR3-07	1.75
PR3-08	2.00
PR3-09	2.25
PR3-10	2.50
PR3-11	2.75
PR3-12	3.00
PR3-13	3.25
PR3-14	3.50
PR3-15	3.75
PR3-16	4.00
PR3-18	4.50
PR3-20	5.00
PR3-22	5.50
PR3-24	6.00
PR3-26	6.50

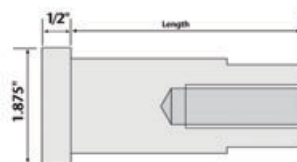

## PT Series

### 0.75" DIAMETER 5/16-18 TAP

ITEM NUMBER	LENGTH
PT0710	1.00
PT0711	1.25
PT0712	1.50
PT0713	1.75
PT0720	2.00
PT0721	2.25
PT0722	2.50
PT0723	2.75
PT0730	3.00
PT0731	3.25
PT0732	3.50
PT0733	3.75
PT0740	4.00
PT0742	4.50
PT0750	5.00
PT0752	5.50
PT0760	6.00
PT0762	6.50

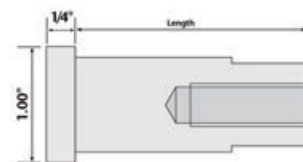

**PT Series**

**1.00" DIAMETER  
3/8-16 TAP**

ITEM NUMBER	LENGTH
PT1010	1.00
PT1011	1.25
PT1012	1.50
PT1013	1.75
PT1020	2.00
PT1021	2.25
PT1022	2.50
PT1023	2.75
PT1030	3.00
PT1031	3.25
PT1032	3.50
PT1033	3.75
PT1040	4.00
PT1042	4.50
PT1050	5.00
PT1052	5.50
PT1060	6.00
PT1062	6.50

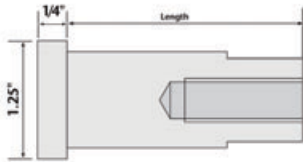

**PT Series**

**1.25" DIAMETER  
1/2-13 TAP**

ITEM NUMBER	LENGTH
PT1111	1.25
PT1112	1.50
PT1113	1.75
PT1120	2.00
PT1121	2.25
PT1122	2.50
PT1123	2.75
PT1130	3.00
PT1131	3.25
PT1132	3.50
PT1133	3.75
PT1140	4.00
PT1142	4.50
PT1150	5.00
PT1152	5.50
PT1160	6.00
PT1162	6.50

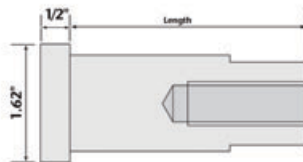

**PT Series**

**1.50" DIAMETER  
5/8-11 TAP**

ITEM NUMBER	LENGTH
PT1212	1.50
PT1213	1.75
PT1220	2.00
PT1221	2.25
PT1222	2.50
PT1223	2.75
PT1230	3.00
PT1231	3.25
PT1232	3.50
PT1233	3.75
PT1240	4.00
PT1242	4.50
PT1250	5.00
PT1252	5.50
PT1260	6.00
PT1262	6.50

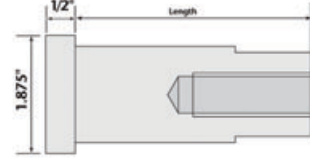

**PC Series**

**0.75" DIAMETER  
5/16" SCREW SIZE**

ITEM NUMBER	LENGTH	COUNTERBORED DEPTH
PC1000	1.00	.50
PC1250	1.25	.50
PC1500	1.50	.50
PC1750	1.75	.50
PC2000	2.00	.50
PC2250	2.25	.50
PC2500	2.50	.50
PC2750	2.75	.50
PC3000	3.00	.50
PC3250	3.25	.50
PC3500	3.50	.75
PC3750	3.75	1.00
PC4000	4.00	1.25
PC4500	4.50	1.75
PC5000	5.00	2.25
PC5500	5.50	2.25
PC6000	6.00	2.50
PC6500	6.50	3.00

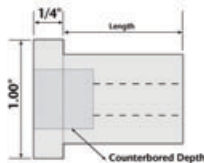

**PRC Series**

**1.00" DIAMETER  
3/8" SCREW SIZE**

ITEM NUMBER	LENGTH	COUNTERBORED DEPTH
PRC1000	1.00	.50
PRC1250	1.25	.50
PRC1500	1.50	.50
PRC1750	1.75	.50
PRC2000	2.00	.50
PRC2250	2.25	.50
PRC2500	2.50	.50
PRC2750	2.75	.50
PRC3000	3.00	.50
PRC3250	3.25	.50
PRC3500	3.50	.75
PRC3750	3.75	1.00
PRC4000	4.00	1.25
PRC4500	4.50	1.75
PRC5000	5.00	2.25
PRC5500	5.50	2.25
PRC6000	6.00	2.50
PRC6500	6.50	3.00

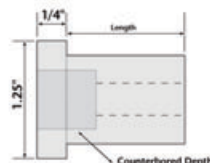

**XPC Series**

**1.25" DIAMETER  
1/2" SCREW SIZE**

ITEM NUMBER	LENGTH	COUNTERBORED DEPTH
XPC1500	1.50	.625
XPC1750	1.75	.625
XPC2000	2.00	.625
XPC2250	2.25	.625
XPC2500	2.50	.625
XPC2750	2.75	.625
XPC3000	3.00	.625
XPC3250	3.25	.625
XPC3500	3.50	.75
XPC3750	3.75	1.00
XPC4000	4.00	1.25
XPC4500	4.50	1.75
XPC5000	5.00	2.25
XPC5500	5.50	2.25
XPC6000	6.00	2.50
XPC6500	6.50	3.00

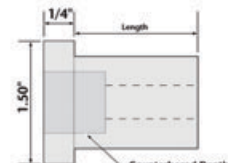



# Metric Pad Retainers

## Reversed Style Spool

### 20mm DIAMETER M8 TAP

ITEM NUMBER	LENGTH
MPT02040	40
MPT02045	45
MPT02050	50
MPT02055	55
MPT02060	60
MPT02065	65
MPT02070	70
MPT02080	80
MPT02090	90
MPT20100	100
MPT20110	110
MPT20120	120
MPT20130	130
MPT20140	140
MPT20150	150

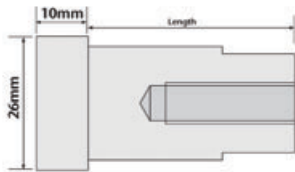

## Reversed Style Spool

### 25mm DIAMETER M10 TAP

ITEM NUMBER	LENGTH
MPT02540	40
MPT02545	45
MPT02550	50
MPT02555	55
MPT02560	60
MPT02565	65
MPT02570	70
MPT02580	80
MPT02590	90
MPT25100	100
MPT25110	110
MPT25120	120
MPT25130	130
MPT25140	140
MPT25150	150

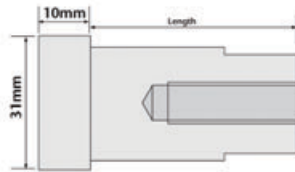

## Reversed Style Spool

### 32mm DIAMETER M12 TAP

ITEM NUMBER	LENGTH
MPT03240	40
MPT03245	45
MPT03250	50
MPT03255	55
MPT03260	60
MPT03265	65
MPT03270	70
MPT03280	80
MPT03290	90
MPT32100	100
MPT32110	110
MPT32120	120
MPT32130	130
MPT32140	140
MPT32150	150

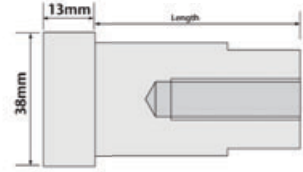

## Locking Style Spool

### 25mm DIAMETER M-10 SCREW SIZE

ITEM NUMBER	LENGTH
MPL02540	40
MPL02545	45
MPL02550	50
MPL02555	55
MPL02560	60
MPL02565	65
MPL02570	70
MPL02580	80
MPL02590	90
MPL25100	100
MPL25110	110
MPL25120	120
MPL25130	130
MPL25140	140
MPL25150	150

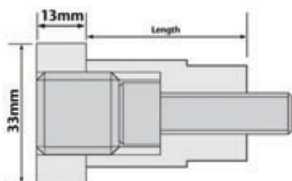

## Locking Style Spool

### 32mm DIAMETER M-12 SCREW SIZE

ITEM NUMBER	LENGTH
MPL03240	40
MPL03245	45
MPL03250	50
MPL03555	55
MPL03260	60
MPL03265	65
MPL03270	70
MPL03280	80
MPL03290	90
MPL32100	100
MPL32110	110
MPL32120	120
MPL32130	130
MPL32140	140
MPL32150	150

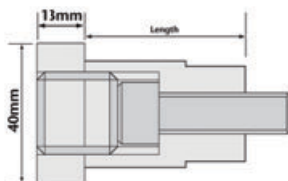

• Amcor Pad Retainers are made from **12L14CRS**

• File hardened to a case depth of **.005/.010**

• Tensile strength is greater than **70,000 PSI**, but less than **85,000**

• Rockwell rating is **C-60** or better

• Tolerances:  
Length:  $\pm .002$   
Diameter:  $+.010$



# Locking Style Pad Retainers

## PLF Series

### 0.75" DIAMETER WITH FLATS 5/16-18 SHCS

ITEM NUMBER	LENGTH
PLF60710	1.00
PLF60711	1.25
PLF60712	1.50
PLF60713	1.75
PLF60720	2.00
PLF60721	2.25
PLF60722	2.50
PLF60723	2.75
PLF60730	3.00
PLF60731	3.25
PLF60732	3.50

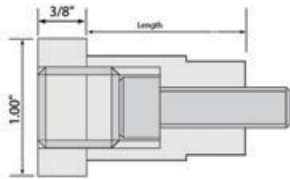

## PLF Series

### 0.812" DIAMETER WITH FLATS 5/16-18 SHCS

ITEM NUMBER	LENGTH
PLF60810	1.00
PLF60811	1.25
PLF60812	1.50
PLF60813	1.75
PLF60820	2.00
PLF60821	2.25
PLF60822	2.50
PLF60823	2.75
PLF60830	3.00
PLF60831	3.25
PLF60832	3.50
PLF60840	4.00
PLF60842	4.50
PLF60850	5.00
PLF60852	5.50
PLF60860	6.00
PLF60862	6.50

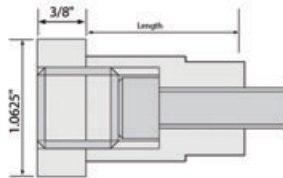

## PLF Series

### 1.00" DIAMETER WITH FLATS 3/8-16 SHCS

ITEM NUMBER	LENGTH
PLF61010	1.00
PLF61011	1.25
PLF61012	1.50
PLF61013	1.75
PLF61020	2.00
PLF61021	2.25
PLF61022	2.50
PLF61023	2.75
PLF61030	3.00
PLF61031	3.25
PLF61032	3.50
PLF61033	3.75
PLF61040	4.00
PLF61042	4.50
PLF61050	5.00
PLF61052	5.50
PLF61060	6.00
PLF61062	6.50

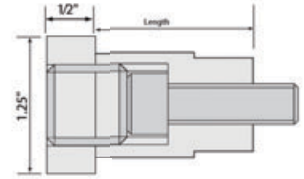

## PLF Series

### 1.25" DIAMETER WITH FLATS 1/2-13 SHCS

ITEM NUMBER	LENGTH
PLF61110	1.00
PLF61111	1.25
PLF61112	1.50
PLF61113	1.75
PLF61120	2.00
PLF61121	2.25
PLF61122	2.50
PLF61123	2.75
PLF61130	3.00
PLF61131	3.25
PLF61132	3.50
PLF61133	3.75
PLF61140	4.00
PLF61142	4.50
PLF61150	5.00
PLF61152	5.50
PLF61160	6.00
PLF61162	6.50

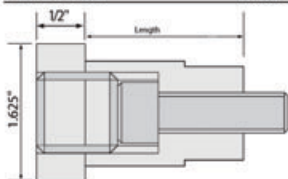

## PLF Series

### 1.50" DIAMETER WITH FLATS 5/8-11 SHCS

ITEM NUMBER	LENGTH
PLF61211	1.25
PLF61212	1.50
PLF61213	1.75
PLF61220	2.00
PLF61221	2.25
PLF61222	2.50
PLF61223	2.75
PLF61230	3.00
PLF61231	3.25
PLF61232	3.50
PLF61233	3.75
PLF61240	4.00
PLF61242	4.50
PLF61250	5.00
PLF61252	5.50
PLF61260	6.00
PLF61262	6.50

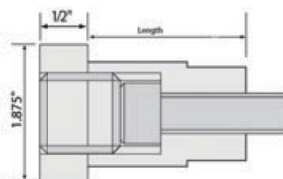

## PLF Series

### 1.62" DIAMETER WITH FLATS 3/4-10 SHCS

ITEM NUMBER	LENGTH
PLF61312	1.50
PLF61313	1.75
PLF61320	2.00
PLF61321	2.25
PLF61322	2.50
PLF61323	2.75
PLF61330	3.00
PLF61331	3.25
PLF61332	3.50
PLF61333	3.75
PLF61340	4.00
PLF61342	4.50
PLF61350	5.00
PLF61352	5.50
PLF61360	6.00
PLF61362	6.50

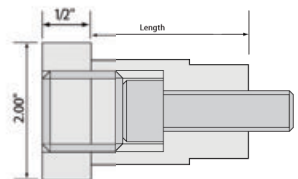



# Counterbored Pad Retainers

## Metric Counterbored Series

### 20mm DIAMETER M8 SCREW SIZE

ITEM NUMBER	LENGTH	COUNTERBORED DEPTH
MS2030	30	15
MS2035	35	15
MS2040	40	15
MS2045	45	15
MS2050	50	15
MS2055	55	15
MS2060	60	15
MS2065	65	15
MS2070	70	15
MS2080	80	27
MS2090	90	27
MS20100	100	27
MS20110	110	27
MS20120	120	27
MS20130	130	27
MS20140	140	27
MS20150	150	27

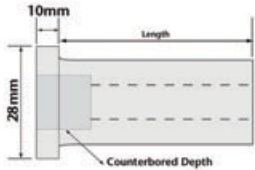

## Metric Counterbored Series

### 25mm DIAMETER M10 SCREW SIZE

ITEM NUMBER	LENGTH	COUNTERBORED DEPTH
MS2530	30	15
MS2535	35	15
MS2540	40	15
MS2545	45	15
MS2550	50	15
MS2555	55	15
MS2560	60	15
MS2565	65	15
MS2570	70	15
MS2580	80	27
MS2590	90	27
MS25100	100	27
MS25110	110	27
MS25120	120	27
MS25130	130	27
MS25140	140	27
MS25150	150	27

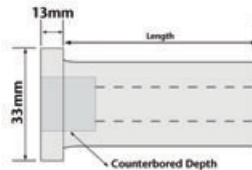

## Metric Counterbored Series

### 32mm DIAMETER M12 SCREW SIZE

ITEM NUMBER	LENGTH	COUNTERBORED DEPTH
MS3240	40	16
MS3245	45	16
MS3250	50	16
MS3255	55	16
MS3260	60	16
MS3265	65	16
MS3270	70	16
MS3280	80	32
MS3290	90	32
MS32100	100	32
MS32110	110	32
MS32120	120	32
MS32130	130	32
MS32140	140	32
MS32150	150	32

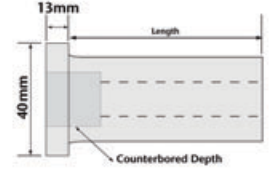

## Set Screws

### STANDARD

ITEM NUMBER	LENGTH	A	B
SHSS0625	5/8-18	3/8	3/8
SHSS0688	11/16-18	3/8	3/8
SHSS0750	3/4-16	3/8	3/8
SHSS0875	7/8-14	3/8	3/8
SHSS1000	1-14	3/8	3/8
SHSS1125	1 1/8-12	3/8	3/8
SHSS1250	1 1/4-12	3/8	3/8
SHSS1500	1 1/2-12	3/8	3/8

### METRIC

ITEM NUMBER	LENGTH	A	B
SHSS18	M18 X 1.50	10	10
SHSS20	M20 X 1.50	10	10
SHSS22	M22 X 1.50	10	10
SHSS24	M24 X 1.50	10	10

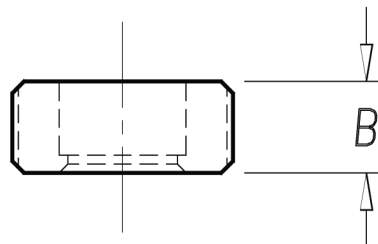
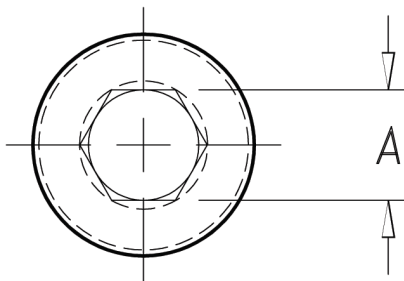

DISTRIBUTED BY:



Applied Mechanics Corporation  
 0-14122 Ironwood Drive N.W.  
 Grand Rapids, MI 49534  
 Toll Free: 800-572-0141  
 Toll Free Fax: 866-677-5969  
 Internet: [www.amcortooling.com](http://www.amcortooling.com)  
 E-mail: [sales@amcortooling.com](mailto:sales@amcortooling.com)  
 Facebook:  
[www.facebook.com/amcortooling](http://www.facebook.com/amcortooling)